

OKUL



BESCHREIBUNG | DESCRIPTION

formschönes Downlight für alle gängigen Lichtband-systeme, erhältlich in verschiedenen Arten der Lichtverteilung

shapely downlight for marketable lighting strip system, available in different types of light distribution

| | |
|---|--|
| Schutzart <i>protection degree</i> | IP40 |
| Schutzklasse <i>protection class</i> | I |
| Gehäuse <i>housing</i> | Stahlblech weiß RAL 9016 <i>steel sheet white RAL 9016</i> |

Serie S

Serie P

Zentralbatterie | *central battery*

TECHNISCHE DATEN | SPECIFICATIONS

| | Anschlussspannung <i>supply voltage (AC/DC)</i> | Anschlussleistung <i>power rating (AC/DC)</i> | Umgebungstemperatur <i>ambient temperature</i> | Gewicht <i>weight</i> | Lichtstrom SO / AO <i>luminous flux</i> |
|---|--|--|---|--------------------------|---|
| Zentralbatterie <i>central battery</i> | 230 V / 216 V | 10,0 VA / 7,0 W | -10° C <> +40° C | 0,4 kg | 588 lm / 550 lm |

OPTIONEN | OPTIONS



SYMMETRISCH (SO)



ASYMMETRISCH (AO)

MAßE | DIMENSION (mm)

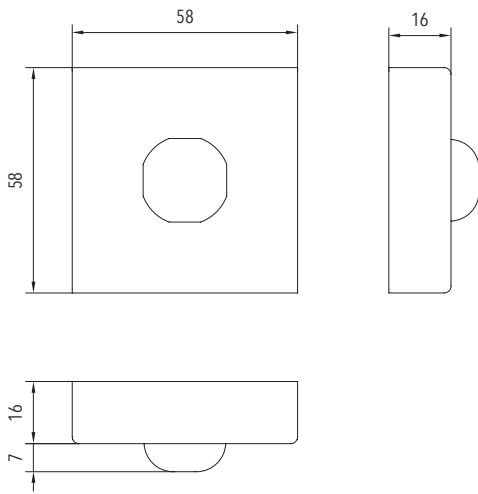

erforderliche Maße des Lichtbandsystems
required dimensions of lighting strip system

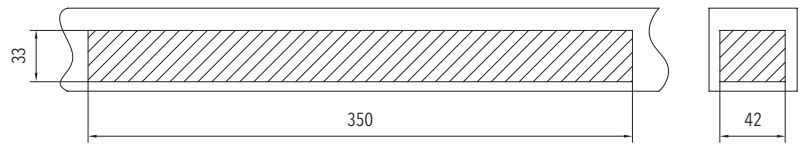

PROJEKTIERUNGSHILFEN | PROJECT PLANNING HELPS

OKULZ SO

588 lm

| Höhe height [m] | Abstand DA distances DA [m] | |
|-----------------------|-----------------------------------|-------|
| | □-□ | □-□ |
| 2,0 | 3,80 | 8,50 |
| 2,5 | 4,50 | 10,00 |
| 3,0 | 5,00 | 11,40 |
| 3,5 | 5,50 | 12,70 |
| 4,0 | 5,90 | 13,90 |
| 5,0 | 6,50 | 15,90 |
| 6,0 | 6,80 | 17,20 |
| 7,0 | 6,80 | 18,30 |
| 8,0 | 6,30 | 19,20 |
| 9,0 | 4,70 | 19,60 |
| 10,0 | 2,80 | 19,30 |



OKULZ AO

550 lm

| Höhe height [m] | Abstand DA distances DA [m] | | | |
|-----------------------|-----------------------------------|-------|-------|------|
| | □-□ | □-□ | □-□ | □-□ |
| 2,0 | 8,90 | 20,30 | 8,10 | 3,30 |
| 2,5 | 10,20 | 23,40 | 8,90 | 3,40 |
| 3,0 | 11,20 | 26,20 | 9,50 | 3,60 |
| 3,5 | 12,00 | 28,80 | 9,80 | 3,70 |
| 4,0 | 12,60 | 31,00 | 10,00 | 3,70 |
| 5,0 | 13,30 | 34,20 | 10,50 | 3,60 |
| 6,0 | 10,70 | 36,30 | 10,50 | 3,30 |
| 7,0 | 9,60 | 36,00 | 10,30 | 2,80 |
| 8,0 | 7,30 | 34,60 | 9,80 | 2,10 |
| 9,0 | 5,20 | 29,20 | 9,00 | 1,00 |

